

© Crown copyright (and database rights) 2023 OS AC0000811047. You are permitted to use this data solely to enable you to respond to, or interact with, the organisation that provided you with the data. You are not permitted to copy, sub-licence, distribute or sell any of this data to third parties in any form.

<p>Draen asgell (fin drain) 100mmØ arfaethedig</p> <p>Pibell ailffa 100mmØ arfaethedig - cyfeirwch at nodyn 2</p> <p>Cysylltiadau ffosydd draenio arfaethedig</p> <p>Wal ben ailffa arfaethedig - cyfeirwch at nodyn 2</p> <p>Siambr archwilio \ twll archwilio arfaethedig</p> <p>Cronfa ddŵr arfaethedig - cyfeirwch at luniad P187-S3-71-08 am fanfynion</p> <p>Ffos ddraenio arfaethedig</p>	<p>Alffedd Key</p> <p>Proposed 100mmØ fin drain</p> <p>Proposed 100mmØ outlet pipe - refer to note 2</p> <p>Proposed drainage ditch connections</p> <p>Proposed outlet headwall - refer to note 2</p> <p>Proposed inspection chamber \ manhole</p> <p>Proposed reservoir - refer to drawing P187-S3-71-08 for details</p> <p>Proposed drainage ditch</p>
--------------------------------------------------------------------------------------------------------------------------------------------------------------------------------------------------------------------------------------------------------------------------------------------------------------------------------------------------------------------------------------------------	----------------------------------------------------------------------------------------------------------------------------------------------------------------------------------------------------------------------------------------------------------------------------------------------------------------------------------------------------------

Nodiadau

- Rhaid darllen y luniad ar y cyd â luniadau P187-S3-71-02 a 03 Trefniadau Cyffredinol, ac Adroddiad Ymchwilad Tir - GC3569-RED-74-ATR-RP-D-0004 P01 RFATR P3.4 a 5 GIR.
- Bydd union leoliad a lfelelau'r siambrau, allffeydd draenio a waliau blaen yn cael eu pennu unwaith y bydd y gwaith dirio llystyfiant wedi'i gwblhau a'r topograffi presennol wedi'i asesu.
- Rhaid i orchuddion a fframiau siambr fod yn y dosbarth D400 yn y rhydwaihaith priffydd ac yn y B125 mewn ardaloedd i gerddwyr, ymylon a thirweidd.
- Bydd cronfeydd dŵr yn cael eu lleoli tua bob 50m a/neu ar waelod y llethrau i gynyddu'r cyfle ymreiddio ac atal cronni ar waelod y rhan o'r llwybr sydd ar lethr. Byddant hefyd yn cael eu defnyddio i gludo liff o'r ffosydd draenio arfaethedig i'r argloddiau cyfagos, lle bydd liffoedd yn cael eu rhyng-gipio gan llystyfiant, gan leihau'r sylweddol gyflymder a maint y dŵr ffo o'r safle. Cyfeirwch at y Strategaeth Ddraenio a luniad P187-S3-71-08 am fanfynion.

Strategaeth Ddraenio - Cam 3
Cynigir defnyddio wyneb asffalt hydraidd ledled y safle gan ganiatáu i'r cynnig terfynol dŵnwarded dŵr ffo naturiol presennol y safle. Bydd dyluniad yr asffalt hydraidd yn amrywio yn dibynnu a yw ar ran wastad y llwybr neu ar ran lethrog y llwybr.

Rhan lethrog
Er mwyn sicrhau bod yr arwyneb hydraidd yn perfformio ar y rhan lethrog, bydd ffosydd llwybr mawr 2m o hyd, y cyfeirir atyn nhw fel 'cronfeydd dŵr', gyda choffer fertigol drwy'r haenau agregau tua gwaelod y llethr yn cael eu hadeiladu i gynyddu'r cyfle ymreiddio ac atal pylillau ar waelod y llethr. Pan fo gan yr arwyneb hydraidd gyfradd ymreiddiad uwch na'r tir presennol gwaelodol, bydd angen i'r arwyneb hydraidd gael ei amddiffyn rhag difrod a chynnal dogelwch gweithredol yn ystod amodau rhewlyd. Ar hyd y rhan lethrog, lle mae'r llwybr yn y rhan lenwi, bydd unrhyw orienwad yn mynd i'r argloddiau cyfagos.

Lle mae'r llwybr yn y rhan toni, bydd ffos fas ar ochr isel y llwybr yn dal unrhyw orienwad. Bydd y ffosydd weddyn yn golwg yn ôl i'r system ymreiddio gan na lyddian nhw belach yn y rhan toni. Cyfeirwch at luniad P187-S3-71-08 am fanfynion cynllun yr arwyneb hydraidd ar hyd y rhan lethrog.

Rhan wastad
Pan fo gan yr arwyneb hydraidd gyfradd ymreiddiad uwch na'r tir presennol gwaelodol, bydd yr arwyneb hydraidd yn cael ei amddiffyn rhag difrod a chynnal dogelwch gweithredol yn ystod amodau rhewlyd trwy gwynys draen asgell gul i'r furfiant is-sylfaen. Cyfeirwch at lun P187-S3-71-06 am fanfynion y dyluniad arwyneb hydraidd ar hyd y rhan wastad.

Notes

- Drawing shall be read in conjunction with drawings P187-S3-71-02 and 03 General Arrangement, and Ground Investigation Report - GC3569-RED-74-ATR-RP-D-0004 P01 RFATR P3.4&5 GIR.
- The exact location and levels of chambers, drain outlets and headwalls shall be determined once vegetation clearance has been completed and existing topography assessed.
- Chamber covers and frames shall be D400 loading in highway network and B125 loading in pedestrian verge and landscape areas.
- Reservoirs will be located at approximately 50m intervals and/or at bottom of slopes to increase infiltration opportunity and prevent ponding at the bottom of the sloped section of the route. They'll also be used to transport flows from the proposed drainage ditches to the adjacent embankments, where flows will be intercepted by vegetation, significantly reducing the speed and quantity of runoff from the site. Refer to the Drainage Strategy and drawing P187-S3-71-08 for details.

Drainage Strategy Phase 3
Permeable asphalt surfacing is proposed across the entire site allowing the final proposal to mimic the sites current natural runoff. The design of the permeable asphalt will differ depending on whether it is on the flat section of the route or on the sloped section of the route.

Sloped Section
To ensure the permeable surfacing performs on the sloped section, large 2m long, width of route trenches, referred to as 'reservoirs', with a vertical slank through the aggregate layers on the down slope side will be constructed to increase infiltration opportunity and prevent ponding at the bottom of the slope. Where the permeable surfacing has a higher infiltration rate than the underlying existing ground, the permeable surfacing will need to be protected from damage and maintain operational safety during freezing conditions. Along the route is in fill, any surcharge will discharge to adjacent embankments. Where the route is in cut, a shallow ditch on the low side of the route will capture any surcharge. The ditches will then discharge back into the infiltration system when no longer in cut. Refer to drawing P187-S3-71-08 for details of the permeable surfacing design along the sloped section.

Flat Section
Where the permeable surfacing has a higher infiltration rate than the underlying existing ground, the permeable surfacing will be protected from damage and maintain operational safety during freezing conditions by the inclusion of a narrow fin drain to the sub-base formation. Refer to drawing P187-S3-71-06 for details of the permeable surfacing design along the flat section.

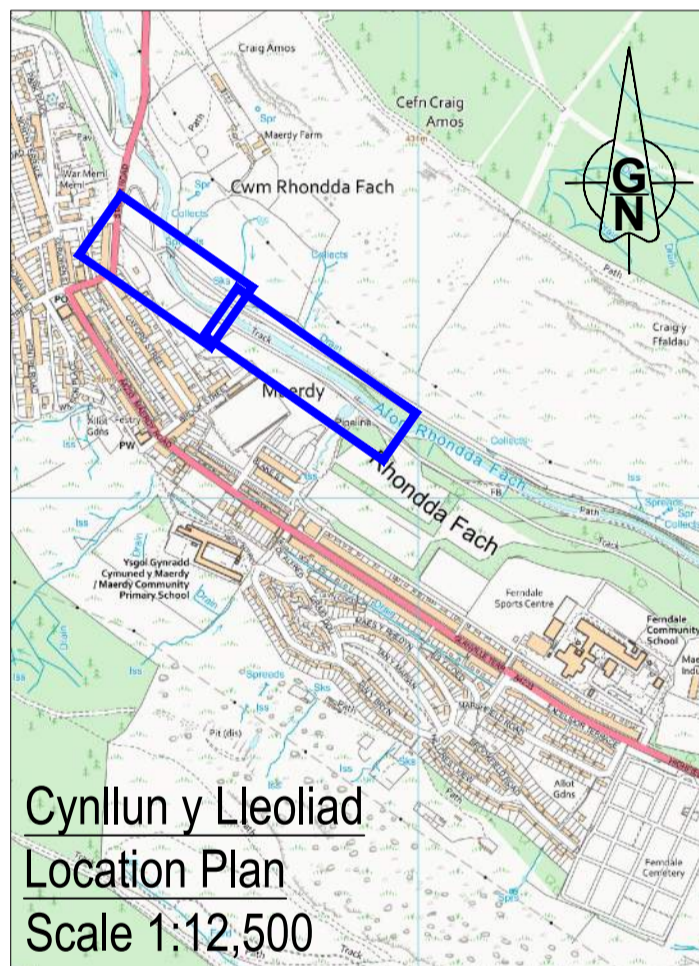
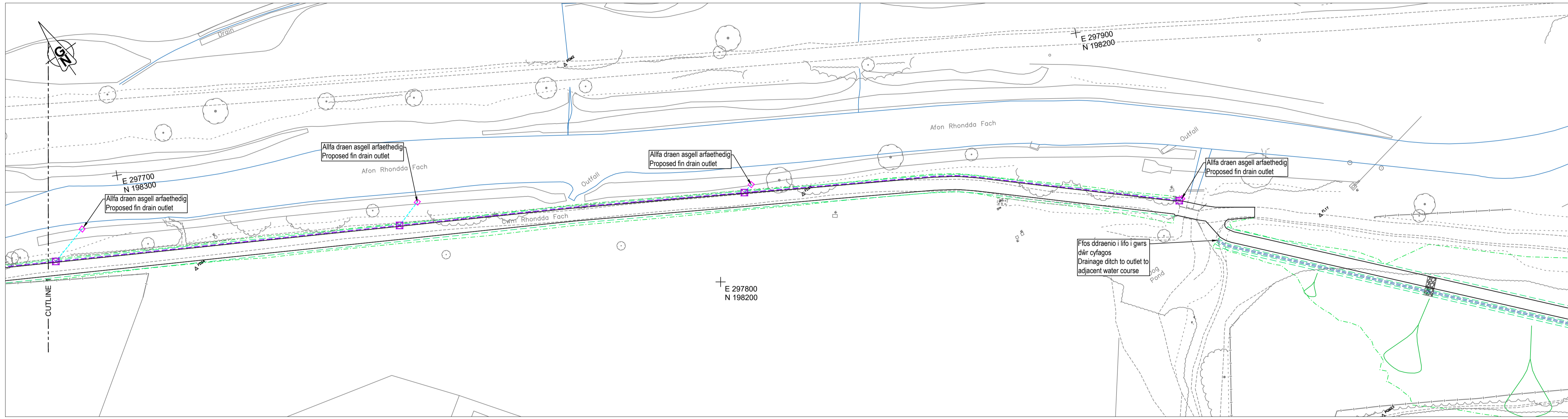

Adelladwaith Palmant Hydraidd Nodweddiadol

Arwyneb 30mm	Typical Permeable Pavement Construction
Rhwymwr 60mm	30mm Surfacing
Cwrs malurion 50mm	60mm Binder
200mm Is-sylfaen Math 3 Agored Wedi'i Raddoli (Yn rhagdybio 5% yn ôl y CBR)	50mm Crush course
Cyfanswm Dyfnder 340mm	200mm Type 3 Sub Base Open Graded (Assumes 5% CBR)
	Total Depth 340mm

Alffeydd draen asgell ysbeidiol ar bwntiau isel ac yn unionlin ar fychau o 100 metr
Intermittent fin drain outlets at low points and linearly approx. 100m intervals

Nodiadau

- Rhaid adeiladu'r ddraen gydag un wyneb geotectsil mewn cysylltiad ag ochr y cloddriad. Rhaid i'r ochr sydd â'r athreiddedd mwyaf fod yn wyneb adelladwaith y palmant ac mewn cysylltiad â'r adelladwaith hwnnw lle bo'n briodol.
- Darpenir draen asgell a allffeydd ar ochr isel y palmant i ddraenio palmant hydraidd mewn sefyllfaedd lle mae'r tir gwaelodol presennol yn ddirlawn yn hydrolog / llai o hydreiddedd.
- Llygaid rhodio i lynu'r afon i'w darparu ar ddraen asgell ar fychau o tua 25 metr.

Notes

- The drain shall be constructed with one geotextile face in contact with the side of the excavation. The side having the greater permeability shall be facing towards and be in contact with the pavement construction where appropriate.
- Fin drain and outlets provided at low side of pavement to drain permeable paving in situations where existing underlying ground becomes hydraulically saturated / reduced permeability.
- Upstream rodding eyes to be provided on fin drain at approx. 25m intervals.

Adelladwaith Palmant Hydraidd Nodweddiadol

Arwyneb 30mm	Typical Permeable Pavement Construction
Rhwymwr 60mm	30mm Surfacing
Cwrs malurion 50mm	60mm Binder
200mm Is-sylfaen Math 3 Agored Wedi'i Raddoli (Yn rhagdybio 5% yn ôl y CBR)	50mm Crush course
Cyfanswm Dyfnder 340mm	200mm Type 3 Sub Base Open Graded (Assumes 5% CBR)
	Total Depth 340mm

Manylion Draen Cul Fin Drain Detail

Notes

- The drain shall be constructed with one geotextile face in contact with the side of the excavation. The side having the greater permeability shall be facing towards and be in contact with the pavement construction where appropriate.
- Fin drain and outlets provided at low side of pavement to drain permeable paving in situations where existing underlying ground becomes hydraulically saturated / reduced permeability.
- Upstream rodding eyes to be provided on fin drain at approx. 25m intervals.

Manylion Adolygiad/Revision Details

Project/Project	GenBy	Dyddiad/Date	Adolygiad/Revision
Llwybr Teithio Llesol Rhondda Fach Luniadau Cynllunio Cam 3			

Rhondda Fach Active Travel Route Phase 3 Planning Drawings

Tafel y Lluwr Dwg Title

Strategaeth Ddraenio (Taflen 1 o 2)

Tafel y Lluwr Dwg No

Drainage Strategy (Sheet 1 of 2)

Rif y Proiect/Project No.	Graddf/Scale @ A1	Dyddiad/Date
P187	1:500	01/24
Tafel y Lluwr Dwg No.		Adolygiad/Revision
P187-S3-71-06		P00

Paratowyd gan/Prepared by: JS

Gwinydd gan/Checked by: RG

Cymeradwydd gan/Approved by: NM

RHONDDA CYNON TAF
PRIFYRDD, GOFAL Y STRYDOEDD A THRAFNDIAETH

RHONDDA CYNON TAF
HIGHWAYS, STREETCARE AND TRANSPORTATION

RHONDDA CYNON TAF
PROSIECTAU STRATEGOL/STRATEGIC PROJECTS
Ty Sardin/Sardin House, Heol Sardin/Sardin Road, Pontypridd, CF37 1DU
Ffôn/Tel: 01443 425001 Ffacs/Fax: 01443 490414