

| Rev. | Amendments | Date | Made By | Chk'd By |
|------|------------|------|---------|----------|
|      |            |      |         |          |
|      |            |      |         |          |

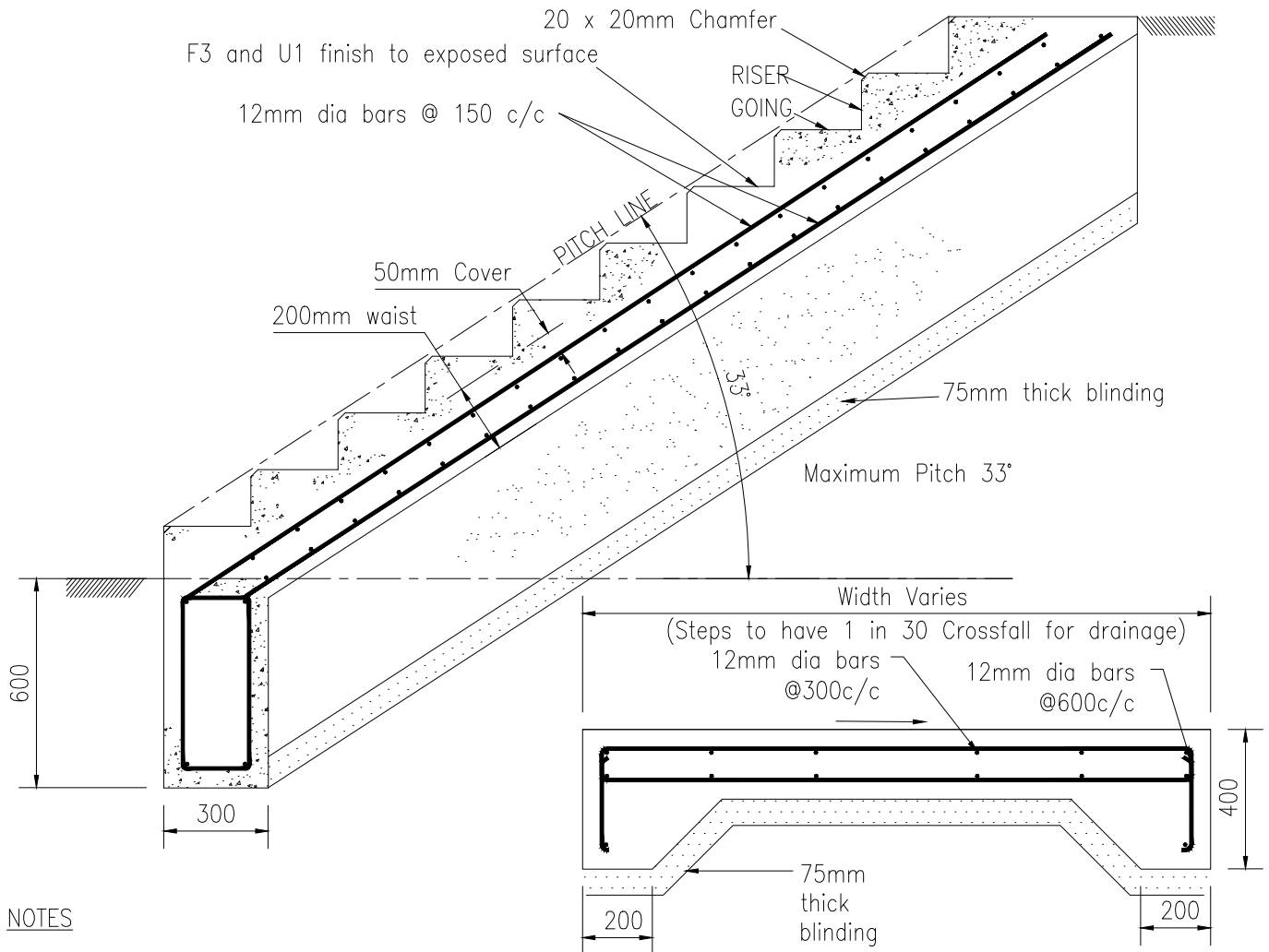

#### NOTES

1. All dimensions are in millimetres.
2. Rise 150mm going 250mm.
3. Minimum cover to reinforcement 50mm.
4. Reinforcement to consist of 12mm high yield steel bars. Alternatively A393 mesh may be utilised.
5. Reinforced concrete to be grade Class 40/20.
6. maximum rise permitted without handrail is 600mm.
7. Minimum unobstructed width to be 1m.
8. Width >1.8m handrails required both sides.
9. Handrail to be tubular steel (Kee Klamp or similar approved), with top and middle rail to ensure rigidity.
10. Layout and detailed design of steps and landings to follow guidance set out in the Department of Transport publication 'Inclusive Mobility'.
11. Long flights of steps must incorporate suitable landings and expansion/contraction joints as necessary.
12. Tactile corduroy pattern buff coloured warning paving must be provided at the top and bottom of the steps.
13. Provision must be made to accommodate surface water run off from the steps.
14. Alternative designs tailored to specific locations may be required and will be subject to approval.

## PUBLIC STAIRWAY

### HIGHWAY DESIGN GUIDE STANDARD DETAILS

**RHONDDA CYNON TAF  
COUNTY BOROUGH COUNCIL**



|          |         |
|----------|---------|
| Drawn    | AM      |
| Checked  | MR      |
| Date     | Apr '11 |
| Scale    | NTS     |
| Drg. No. | 263     |
| Rev.     |         |