

RHONDDA CYNON TAF COUNTY BOROUGH COUNCIL

MUNICIPAL YEAR 2014 - 2015

COUNCIL
22nd April 2015

Agenda Item No.9

**REPORT OF THE DIRECTOR OF
LEGAL AND DEMOCRATIC SERVICES**

**COMMUNITY AND ELECTORAL
ARRANGEMENTS REVIEW –
RESPONSE OF BOUNDARY
COMMISSION**

Author: Mr. P.J. Lucas, Director Legal and Democratic Services
Tel: (01443) 424105

1. PURPOSE OF REPORT

- 1.1 The purpose of the report is to seek Council's view on the responses received from the Local Democracy and Boundary Commission for Wales (LDBCW) affecting the numbers of Community and Town Councillors in Pontypridd, Llantwit Fardre and Llantrisant areas.

2. RECOMMENDATIONS

It is recommended that Council consider whether to:

- 2.1 Endorse proposals of the LDBCW with regard to Town and Community Councillor numbers as set out in paragraph 5, 6 and 7 of the report.
- 2.2 Agree the changes to proposal C1.
- 2.3 Agree the new proposal L1.
- 2.4 Agree to defer proposal F2.

3. BACKGROUND

- 3.1 At the meeting held on the 23rd July 2014, Council approved the review of Community Boundaries and Electoral Arrangements for submission to the LDBCW. Report attached at Appendix 1 – hyperlink to Appendices:
<http://www.rctcbc.gov.uk/en/councildemocracymeeetings/council/2014/07/23/council23-jul-2014.aspx>
- 3.2 Having submitted the Review, I have now received a response from the LDBCW with draft proposals that will affect Community and Town Councillor numbers in Pontypridd, Llantwit Fardre and Llantrisant. The LDBCW believe

the proposals will give a fairer representation to the electorate within the areas affected. The reason for the proposals can be seen in the improvement in the variances in the tables set out in paragraphs 5, 6 and 7 below.

4. PROPOSALS OF THE LDBCW

4.1 The detailed proposals for the areas affected are set out in paragraphs 5, 6 and 7 below:

5. PONTYPRIDD TOWN COUNCIL

5.1

Current Arrangements					Local Democracy & Boundary Commission for Wales Proposals			
Ward	Electors	Community Councillors	Electors per Councillor	Variance	Electors	Community Councillors	Electors Per Councillor	Variance
Glyncoch	2128	2	1064	-9%	2128	2	1064	-9%
Cilfynydd	2010	2	1005	-3%	2010	2	1005	-3%
Rhondda	3517	3	1172	-21%	3517	4	879	10%
Pontypridd Town	2186	2	1093	-12%	2186	2	1093	-12%
Trallwng	2852	3	951	2%	2852	3	951	2%
Ilan	934	1	934	4%	934	1	934	4%
Rhydfelen Central	2079	2	1040	-7%	2079	2	1040	-7%
Rhydfelen Lower	1326	1	1326	-36%	1326	1	1326	-36%
Hawthorn	1568	2	784	19%	1568	2	784	19%
Treforest	2006	3	669	31%	2006	2	1003	-3%
Graig	1748	2	874	10%	1748	2	874	10%
TOTAL	22354	23	972		22354	23	972	

5.2 As can be seen from the table above the (LDBCW) have taken the total number of electorate for Pontypridd Town Council and divided this figure by the current number of Community Councillors, this equates to 972 electorate per councillor. They have then looked at the composition of the eleven Town Council Wards and aimed to get the electorate to councillor figure as close to the 972 as possible. Their recommendations are a reduction of one Town Councillor for the Treforest Ward, and increase of one Town Councillor for the Rhondda Ward and no change to the Glyncoch, Cilfynydd, Pontypridd Town, Trallwng, Ilan, Rhydfelen Central, Rhydfelen Lower, Hawthorn and Graig Wards. This would result in the number of Town Councillors on the Pontypridd Town Council remaining at Twenty Three.

6. LLANTRISANT COMMUNITY COUNCIL

6.1

Current Arrangements					Local Democracy & Boundary Commission for Wales Proposals			
Ward	Electors	Community Councillors	Electors per Councillor	Variance	Electors	Community Councillors	Electors Per Councillor	Variance
Tyn-Y-Nant	2484	3	828	1%	2484	3	828	1%
Beddau	2942	4	736	12%	2942	4	736	12%
Llantrisant Town	3394	4	849	-2%	3394	4	849	-2%
Talbot Green	2037	2	1019	-22%	2037	3	679	19%
Total for Llantrisant CC	10857	13	835		10857	14	766	

6.2 As you will see from the table above the (LDBCW) have taken the total number of electorate for Llantrisant Community Council and divided this figure by the current number of Community Councillors, this equates to 835 electorate per councillor. They have then looked at the composition of the 4 Community Council Wards and aimed to get the electorate to councillor figure as close to the 835 as possible. Their recommendations are an increase of one Community Councillor for the Talbot Green Ward and no change to the Tyn-Y-Nant, Beddau and Llantrisant Town Wards. This would result in the number of Community Councillors on the Llantrisant Community Council increasing by one to fourteen.

7. LLANTWIT FARDRE COMMUNITY COUNCIL

7.1

Current Arrangements					Local Democracy & Boundary Commission for Wales Proposals			
Ward	Electors	Community Councillors	Electors per Councillor	Variance	Electors	Community Councillors	Electors Per Councillor	Variance
Tonteg	3283	4	821	24%	3283	3	1094	-2%
Church Village	3772	3	1257	-17%	3772	4	943	13%
Llantwit Fardre	3780	3	1260	-17%	3780	4	945	12%
Efail Isaf	1021	1	1021	5%	1021	1	1021	5%
Total for Llantwit Fardre CC	11856	11	1078		11856	12	988	

7.2 As you will see from the table above the (LDBCW) have taken the total number of electorate for Llantwit Fardre Community Council and divided this figure by the current number of Community Councillors, this equates to 1078 electorate per councillor. They have then looked at the composition of the 4 Community Council Wards and aimed to get the electorate to councillor figure as close to the 1078 as possible. Their recommendations are a reduction of one Community Councillor for the Tonteg Ward, and increase of one Community Councillor for both the Church Village and Llantwit Fardre Wards and no change to the Efail Isaf Ward. This would result in the number of Community Councillors on the Llantwit Fardre Community Council increasing by one to twelve.

8. The LDBCW have confirmed they will not proceed with the proposals without the explicit consent of this Council. I have written to the Town and Community Council Clerks of the areas affected and been advised that I should be in receipt of their comments by 22nd April. Given the tight timescale an oral update will be provided at the Meeting.

9. OTHER MATTERS

9.1 The LDBCW have also raised queries in respect of proposal C1 (Llantwit Town / Talbot Green Boundary Change) and proposal F2 (Llanharran / Llanhilid Boundary Change)

9.2 In addition the LDBCW have raised a new proposal L1 (Aberaman – Cwmbach Boundary Change).

10. C1 LLANTWIT TOWN / TALBOT GREEN BOUNDARY CHANGE

10.1 The LDBCW have proposed an amendment to the proposal C1 because of the effect on the property known as “Rhiw Gog” (see plan at Appendix 2). I have advised the Clerk of the Llantrisant Community Council and will give an oral update at the Meeting.

11. F2 LLANHARAN / LLANILID BOUNDARY CHANGE

11.1 The LDBCW have raised the issue of future development in the locality. I have discussed the matter with the Clerk of the Llanharan Community Council and would seek Council’s views on whether it would be appropriate (given the circumstances) to defer consideration of this change. (See plan at Appendix 3).

12. L1 ABERAMAN – CWMBACH BOUNDARY CHANGE

12.1 The LDBCW at proposing a very minor change with regard to the road access to the west of “Aberdare” Asda and the roundabout and road leading to Cwmbach. The proposal will not affect any dwellings or properties (See plan at Appendix 4).

13. CONCLUSION

- 13.1 Council's views are sought on whether to agree the changes to the electoral numbers of Pontypridd Town, Llantwit Fardre and Llantrisant Community Councils; the changes to proposal C1, the new proposal L1 and the deferral of proposal F2.

LOCAL GOVERNMENT ACT 1972

as amended by

LOCAL GOVERNMENT (ACCESS TO INFORMATION) ACT 1985

RHONDDA CYNON TAF COUNTY BOROUGH COUNCIL

LIST OF BACKGROUND PAPERS

COUNCIL

22nd APRIL 2015

REPORT OF THE DIRECTOR OF LEGAL AND DEMOCRATIC SERVICES

REPORT

OFFICER TO CONTACT

**COMMUNITY AND ELECTORAL
ARRANGEMENTS REVIEW – RESPONSE
OF BOUNDARY COMMISSION**

**Paul Lucas
Tel. 01443 424105**

APPENDIX 1

RHONDDA CYNON TAF COUNTY BOROUGH COUNCIL

MUNICIPAL YEAR 2014 -2015

COUNCIL
23rd July 2014

Agenda Item No.9

**REPORT OF THE DIRECTOR OF
LEGAL AND DEMOCRATIC SERVICES**

**COMMUNITY BOUNDARIES AND
ELECTORAL ARRANGEMENTS
REVIEW**

Author: Mr. P.J. Lucas, Director Legal and Democratic Services
Tel: (01443) 424105

1. PURPOSE OF REPORT

1.1 The purpose of the report is to seek Council's approval of the Final Proposals of the Community Review so they may be forwarded to the Local Government Boundary Commission for Wales.

2. RECOMMENDATION

2.1 That Council approve the Final Proposals for the Review of Community Boundaries and Electoral Arrangements as set out in the Appendix to this report at pages 143-154.

3. BACKGROUND

3.1 Sections 55 and 57 of the Local Government Act 1972 require the Council to keep under review Community Areas (Boundaries) and Community Electoral Arrangements. The Local Government (Wales) Measure 2011 amended the 1972 Act to require the Council to publish every 15 years a report of how it has discharged the functions. The last Review was undertaken in 2005.

3.2 The current Review builds upon the 2005 Review and takes into account a number of anomalies that have arisen mainly as a result of new housing developments.

3.3 An extensive consultation process was begun on 1st June 2013 including Members, Community Councils, members of the public and interested parties. All were invited to contribute to and comment upon the Review.

3.4 The Corporate Services Scrutiny Committee were also consulted as a stakeholder and a working group was set up to contribute to the Review.

3.5 Comments and submissions were made at two stages of the Review; the preliminary investigation where comments informed the draft proposals and subsequently the consultation on the draft proposals which informed the Final Proposals.

3.6 Welsh Government Officers have confirmed the importance of completing the Community Review notwithstanding any uncertainty arising from the Williams Report. The Community Boundaries constitute the building blocks upon which any future arrangements (whatever they may be) will be built.

4. FINAL PROPOSALS

4.1 The Final Proposals of the Review are set out in the Appendix to this report.

4.2 Thirty seven Communities/Community Wards have no changes proposed for them. They are:

Cwm Clydach	Cymmer	Ferndale
Llwynypia	Maerdy	Pentre
Penygraig	Porth	Tonypandy
Trealaw	Trehafod	Treherbert
Treorchy	Tylorstown	Ynyshir
Ystrad		
Abercynon	Hirwaun	Llwydcoed
Rhigos	Penrhiwceiber	Penywaun
Cilfynydd	Gilfach Goch	Glyncoch
Hawthorn	Llanharry	Pontyclun
Pontypridd Town	Rhondda	Rhydfelen/Ilan
Taffs Well	Trallwng	Tonteg
Tonyrefail	Treforest	Ynysybwl

4.3 Thirteen Communities have one or more changes proposed for them. They are:

Aberaman	Aberdare	Cwmbach
Mountain Ash		
Beddau	Brynna	ChurchVillage
Graig	Llanharan	Llantrisant Town
Llantwit Fardre	Talbot Green	Tyn-y-Nant

4.4 Nine of the proposals, listed below, received no objections. They are:

CBR	A2	Tyn-y-Nant/Llantwit Fardre Boundary Change
	B1	Llantwit Fardre/Tyn-y-Nant Boundary Change

- B2 Church Village/Llantwit Fardre Boundary Change
- C1 Llantwit Town/Talbot Green Boundary Change
- C2.1 Llantwit Fardre/Tyn-y-Nant/Llantrisant Boundary Change
- C3.2 Beddau/Llantrisant Town Boundary Change
- F1 Llanharan/Brynna Boundary Change
- F2 Llanharan/Llanilid Boundary Change
- H1 Communities of Aberaman, Aberdare and Mountain Ash to be split to overcome electoral division anomaly.

4.5 Four of the proposals, listed below, were subject to objections but were recommended by the Scrutiny Working Group and are included in the Final Proposals.

- CBR A1 Graig/Beddau Boundary Change
- D1 Church Village/Llantwit Fardre Boundary Change
- E1 Church Village/Llantwit Fardre Boundary Change
- G1 Cwmbach/Mountain Ash Boundary Change

5. CONCLUSION

5.1 Council is recommended to approve the Final Proposals so they may be forwarded to the Local Government Boundary Commission for Wales.

Council Meeting - 22nd April, 2015

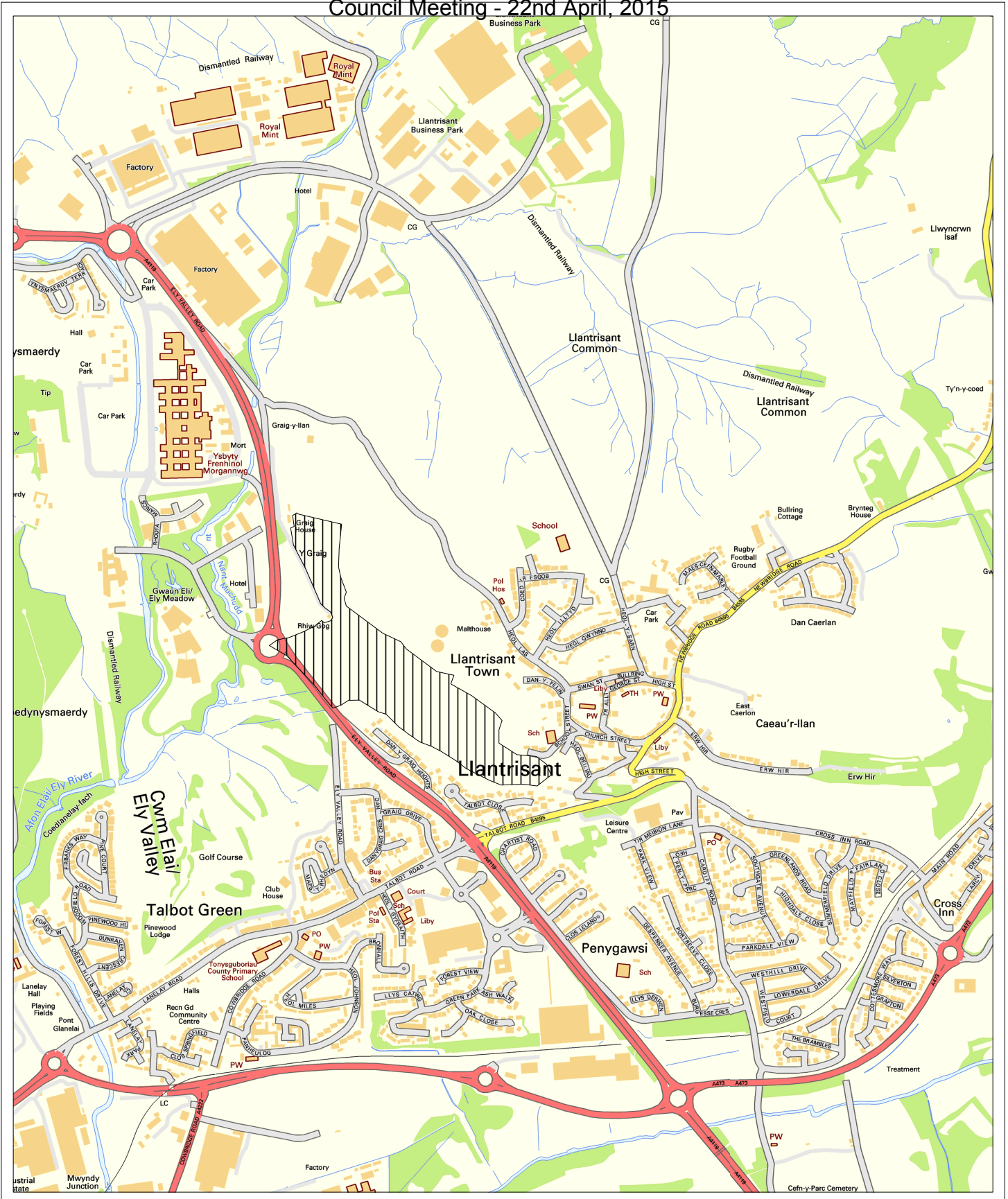

 <p>STRONG HERITAGE STRONG FUTURE RHONDDA CYNON TAF TREFTADAETH GADARN DYFODOL SICR</p>	Drawing Title	Date	Scale	
		Location	e: 000000, n: 000000	
		(C) Crown copyright. All rights reserved LA 100023458. 2006		
	(C) Hawlfraint y Goron. Cedwir pob hawl LA 100023458. 2006			

This page intentionally blank



 <p>STRONG HERITAGE STRONG FUTURE RHONDDA CYNON TAF TREFTADAETH GADARN DYFODOL SICR</p>	<p>Drawing Title Proposal F2 Transfer from Llanilid Community Ward of Llanharan, to Llanharan Community Ward of Llanharan</p>	<p>Date .</p>	<p>Scale .</p>	<p>Location .</p>
	<p>Red Boundary - Existing Llanilid Community Ward</p>	<p>Reproduced from Ordnance Survey with permission of the Controller of Her Majesty's Stationary Office (C) Crown copyright. Unauthorised reproduction infringes Crown copyright and may lead to prosecution/civil proceedings. LICENCE No LA 100023458. 2006</p>		
	<p>Blue Boundary - Existing Llanharan Community Ward</p> <p>Hatched area - proposed Boundary change</p>	<p>Atgynhychwyd o Fapiau'r Ordnance Survey gyda chaniatad Rheolwr Llyfrfa Ei Mawrhydi (C) Hawlfraint y Goron. Y mae atgynhychu heb awdurdod yn torri Hawlfraint y Goron a gall arwain at erlyniad neu achosion sifil. RHIF Y TRWYDDED LA 100023458. 2006</p>		

This page intentionally blank

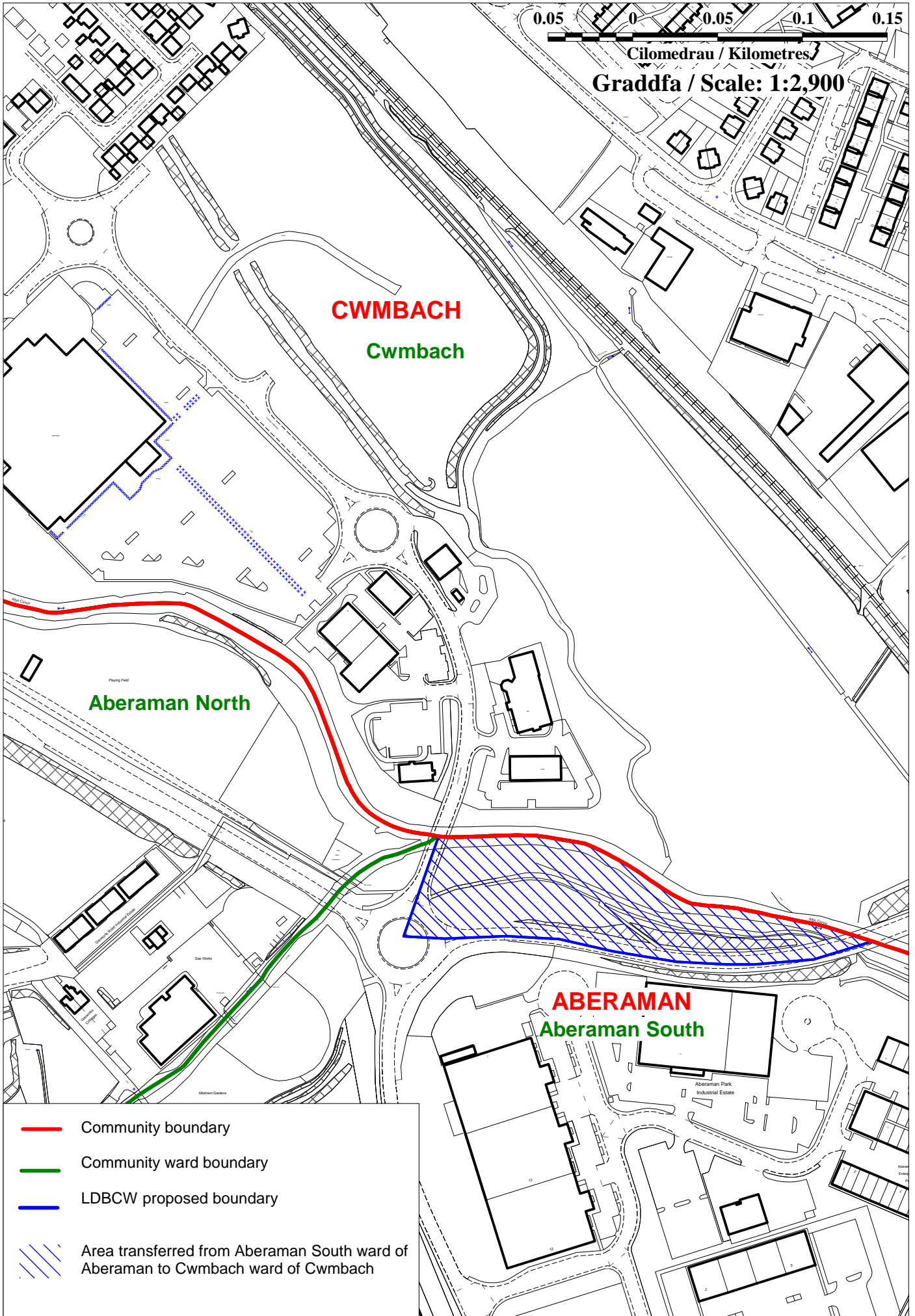

This page intentionally blank